

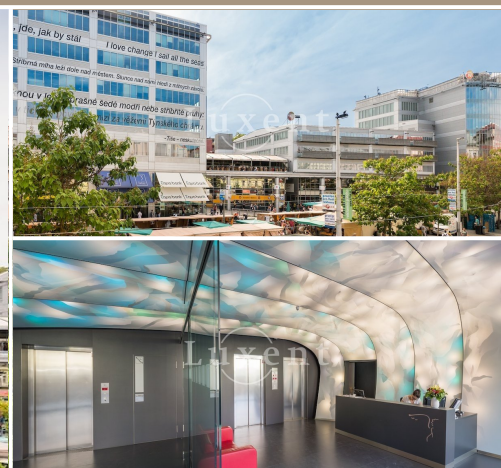

## Commercial unit for rent in Zlatý Anděl building, 345 sqm, Smichov - Prague 5

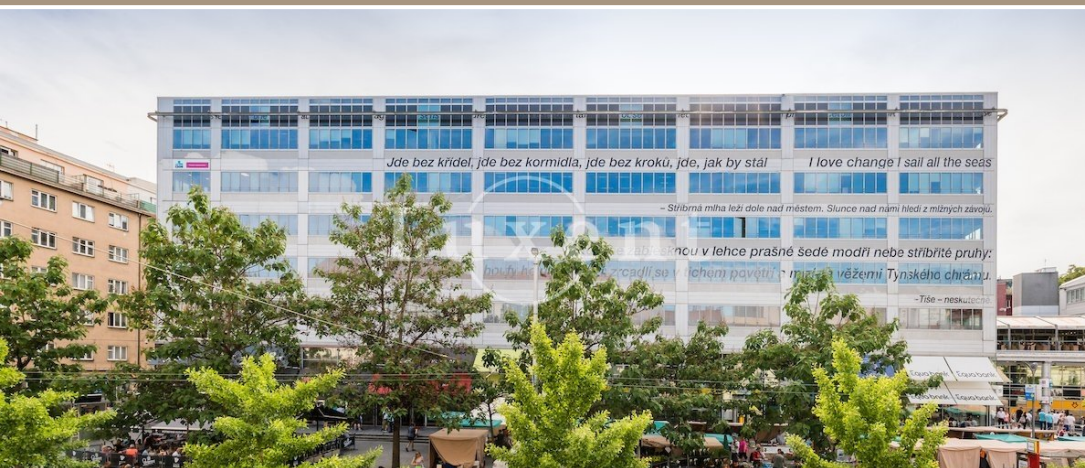

345 m<sup>2</sup> Nádražní, Praha 5 - Smíchov on request



WITH THIS PROPERTY, YOU'LL BE ASSISTED BY

**Anna-Mariia Liubun**  
ASSISTANT

annamariia.liubun@luxent.cz  
+420 770 189 189

Order number	<b>N6760</b>	Price	<b>on request</b>
Address	<b>Nádražní, Praha 5 - Smíchov</b>	Type	<b>Bussiness Units</b>
Usable area	<b>345 m<sup>2</sup></b>	Parking	<b>Yes</b>
Low energy	<b>No</b>	Energy performance of the building	<b>G - Extremely uneconomical</b>
Floor	<b>2nd floor</b>	Device	<b>Yes</b>
Lift	<b>Yes</b>	Date to move in	<b>8. 1. 2024</b>

## About real estate

We offer for rent a beautiful commercial unit in a prestigious location in Prague 5 - Smíchov, located in the iconic Zlatý Anděl building. These offices are available either fully furnished or vacant, ready to be fitted out to your exact requirements.

The Zlatý Anděl Centre, where the offices are located, is on the 2nd floor of this dominant and architecturally significant building designed by world-renowned architect Jean Nouvel. This location offers excellent transport links, being directly above the Anděl B metro station and in the heart of Smíchov, which is known for its rapid development, modern offices, shopping centre, cinemas and vibrant business environment.

The business centre offers 22,000 sqm of lettable space, including 27 fully equipped offices. Clients benefit from an elegant reception area, two modern meeting rooms, a kitchen and technical facilities, including covered parking for maximum convenience. Air conditioning, service and maintenance, 24/7 security and underground parking are also available.

Available immediately.